

# Aluminum

Fixed Window  
Thermally Improved

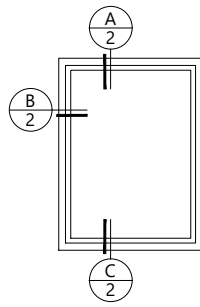

Fixed

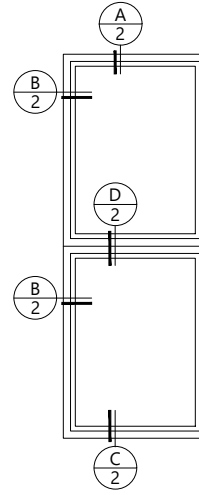

Fixed Over Fixed  
Non-integral Join

Scale: 1/2" (13) = 1' (305)

**Notes:**

Details have been optimized for use in architectural software and do not match manufacturing specifications.  
Dimensions in parentheses are in millimeters.  
Andersen Windows, Inc. reserves the right to change drawing specifications without notice.

Date: 05/30/23

# Aluminum

Fixed Window  
Thermally Improved

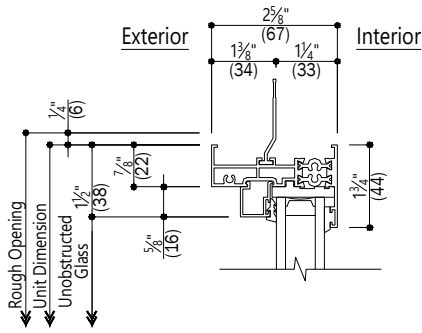

A Head  
2 Fixed

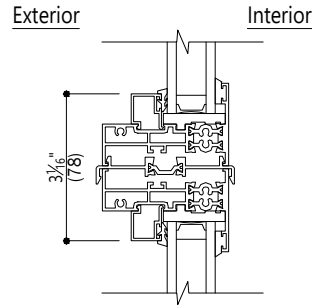

D Horizontal Join  
2 Fixed/Fixed

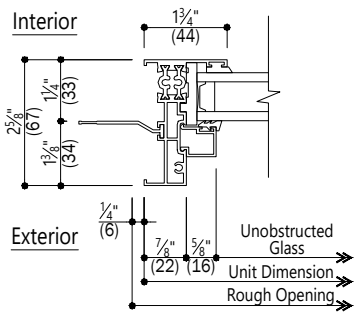

B Jamb  
2 Fixed

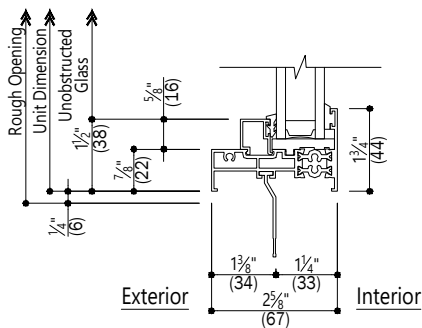

C Sill  
2 Fixed

Scale: 3" (76) = 1' (305)

**Notes:**

Details have been optimized for use in architectural software and do not match manufacturing specifications. Dimensions in parentheses are in millimeters. Andersen Windows, Inc. reserves the right to change drawing specifications without notice.

Date: 05/30/23

# Aluminum

Fixed Window  
Thermally Improved

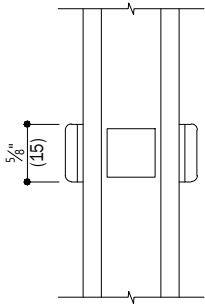

**A**  
3 5/8" Full Divided Light (Flat)

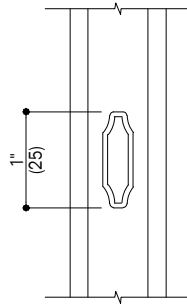

**D**  
3 1" Finelight (Contoured)

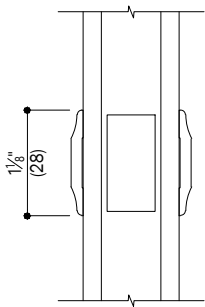

**B**  
3 1 1/8" Full Divided Light (Contoured)

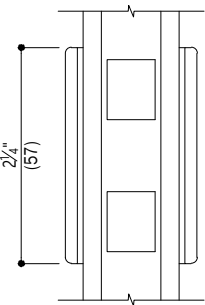

**C**  
3 2 1/4" Full Divided Light (Flat Grille)

Scale: 6" (152) = 1' (305)

**Notes:**

Details have been optimized for use in architectural software and do not match manufacturing specifications.  
Dimensions in parentheses are in millimeters.  
Andersen Windows, Inc. reserves the right to change drawing specifications without notice.

Date: 05/30/23